

## EB804140

### LED lights • Machine and bench lights

LED Gooseneck light, 500x80mm, White light, 9W, 5000lx, 5000K, 230V AC, Socket outlet with protective contact, straight 3pin 3m, IP65, Aluminum+Safety glass, Screw-on plate, Dimmable, On/Off switch

including 4x Screw, 1x Sealing



LED lights are required in nearly every industrial sector. A lighting coordinated on the respective workplace ensures a better visibility, increases the production quality, the working safety and helps additionally to save energy costs. Their long lifetime, which is independent of switching cycles, reduces maintenance costs and increases the availability. LED lights are used for the illumination of workplaces, work areas of machines, control cabinets and several other fields of application.

#### Electrical features

Type of electrical connection	Socket outlet with protective contact, straight
Rated operating current	40mA
Operating voltage (AC 50Hz)	230V
Power	9W
Number of pins	3
Protection class	I
Reverse polarity protection	No

#### Mechanical features

Number of cores	3
Type of lamp stand	Screw-on plate
Design	Gooseneck
Width	80mm
Cable length	3m
Length	500mm
Degree of protection (IP)	IP65
Front screen scattering behavior	clear
Ambient temperature	-10 - 50°C
Housing material	Aluminum

#### Optical features

Illuminance at 500mm distance	7000lx
Color temperature	5000K
Light source	White light
Angle of beam spread	30°

## Other features

Version	Gooseneck light
Risk group	1

## Classification

ETIM 8	EC000348 Machine and workbench light
eClass 7.0	27119010
eClass 7.1	27119010
eClass 8.0	27119010
eClass 9.0	27110345
eClass 9.1	27110345

## More

IPF Product Group	190 machine illuminations
packaging dimensions	875 x 150 x 140 mm
gross weight	2095 g
Customs tariff number	94054239
WEEE number	40951076
Reach-compliant	No

## Dimensional drawing

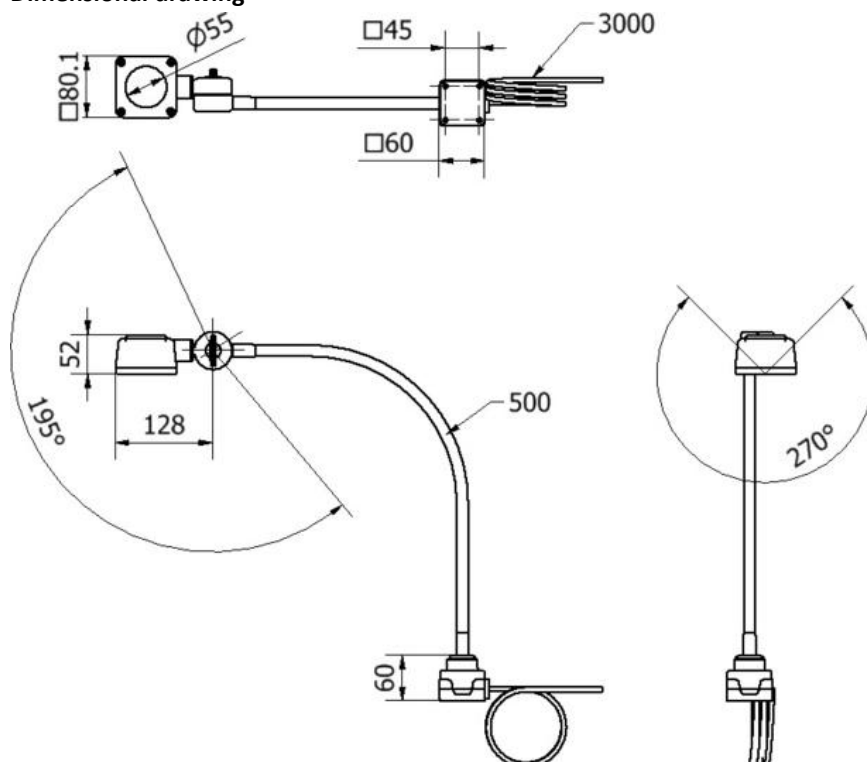

## Connection

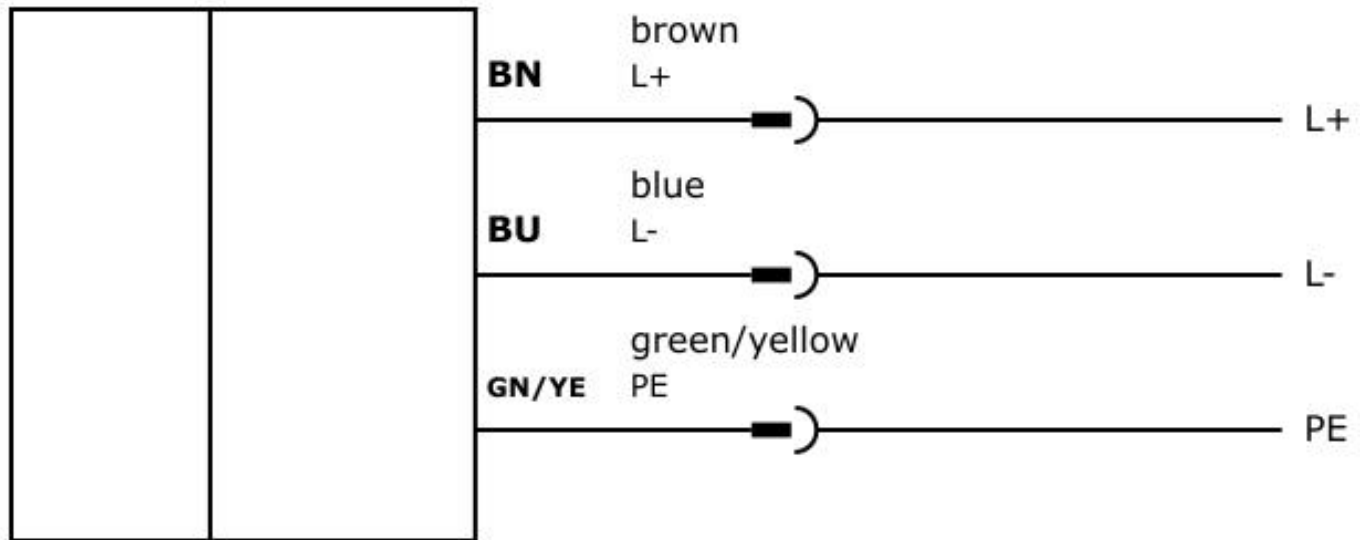

## Installation



Mounting / installation may only be carried out by a qualified electrician!

## Disposal



## Safety warnings

Before initial operation, please make sure to follow all safety instructions that may be provided in the product information.

Never use these devices in applications where the safety of a person depends on their functionality.

For suitable connection and mounting accessories, please refer to our website [www.ipf-electronic.com](http://www.ipf-electronic.com).

LED lighting systems can generate intensive UV radiation, which can damage your eyes in case of improper use. The manufacturer cannot be held responsible for damages that result from improper use or connection.