



# BELLOW-FLEX

## FLEXIBLE METAL BELLOWS COUPLINGS

- High absorption of misalignments
- Elimination of loads on the shafts due to misalignment
- No wear and tear or fatigue
- No cinematic errors in transmission
- High torsional stiffness



BELLOW-FLEX couplings are based on the use of flexible metal bellows that can transmit the moment of rotation while compensating for errors of alignment without hardly any distortion due to torsional elasticity. The characteristics of the BELLOWS-FLEX produce speed transmission of great precision, including high torque and speeds, which recommend them for servo-actions, precision

machinery, installation of control and measurement, etc.

The number of convolutions in the bellow has been chosen in the search for a compromise between the transmittable torque and the admissible misalignments.

### TECHNICAL SPECIFICATIONS

	Torque max. <i>Ncm</i>	Clamping torque max. <i>Ncm</i>	Max. Speed <i>rpm</i>	Admissible max. misalignment			Torsion spring stiffness <i>Nm/rad</i>	Radial spring stiffness <i>N/mm</i>	Weight <i>gr</i>	Inertia <i>gcm<sup>2</sup></i>
				Angular <i>degree</i>	Axial <i>mm</i>	Radial <i>mm</i>				
<b>BFP 1222</b>	15	50	10000	±2,5	±0,4	±0,2	45	30	8	1,8
<b>BFP 1520</b>	40	70	10000	±3	±0,4	±0,2	90	40	6	2
<b>BFP 1525</b>	40	70	10000	±4	±0,5	±0,3	70	15	7	2,3
<b>BFP 2029</b>	120	150	10000	±4	±0,4	±0,25	150	25	15	8
<b>BFP 2035</b>	100	150	10000	±4	±0,5	±0,3	150	10	16	9
<b>BFP 2533</b>	200	80	10000	±8	±2,77	±0,46	210	29	19,5	16,1
<b>BFA 1622</b>	40	50	10000	±3	±0,4	±0,2	90	40	6	2,1
<b>BFA 2129</b>	120	100	10000	±4	±0,4	±0,25	150	25	15	9
<b>BFA 2135</b>	100	100	10000	±4	±0,5	±0,3	140	10	16	9,5
<b>BFA 2435</b>	100	100	10000	±4	±0,5	±0,3	140	10	18	15,2
<b>BFA 2537</b>	200	66	10000	±8	±2,77	±0,46	210	29	28,5	25,4



# BELLOW-FLEX

## FLEXIBLE METAL BELLOWS COUPLINGS

### BFP 1222

Ordering code example: BFP 1222 06/06

∅ d1/d2

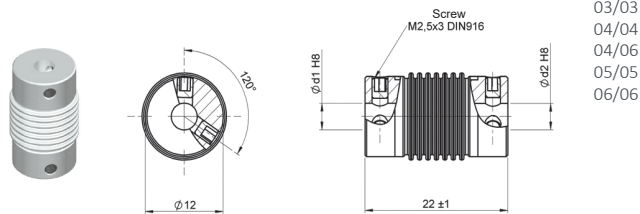

03/03  
04/04  
04/06  
05/05  
06/06

### BFP 1520

Ordering code example: BFP 1520 06/06

∅ d1/d2

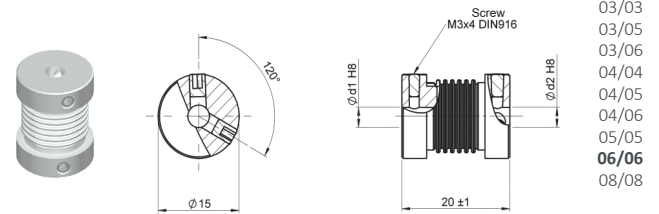

03/03  
03/05  
03/06  
04/04  
04/05  
04/06  
05/05  
**06/06**  
08/08

### BFP 1525

Ordering code example: BFP 1525 03/03

∅ d1/d2

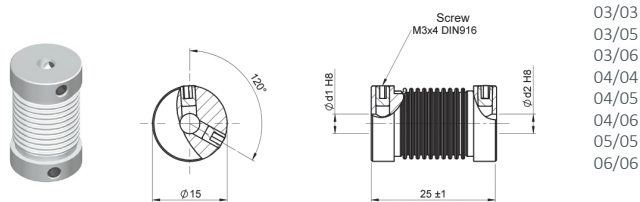

03/03  
03/05  
03/06  
04/04  
04/05  
04/06  
05/05  
06/06

### BFP 2029

Ordering code example: BFP 2029 12/12

∅ d1/d2

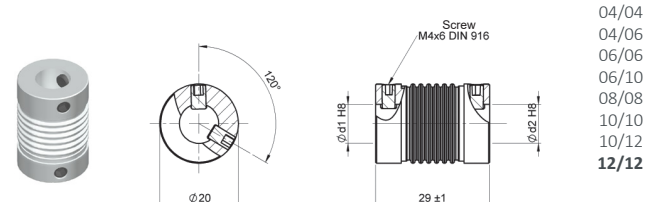

04/04  
04/06  
06/06  
06/10  
08/08  
10/10  
10/12  
**12/12**

### BFP 2035

Ordering code example: BFP 2035 10/10

∅ d1/d2

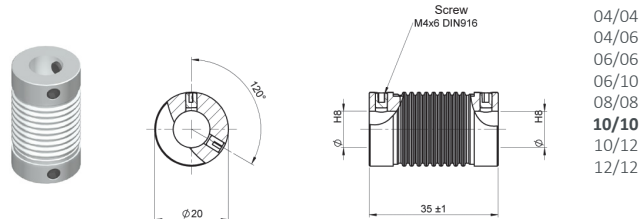

04/04  
04/06  
06/06  
06/10  
08/08  
**10/10**  
10/12  
12/12

### BFP 2533

Ordering code example: BFP 2533 10/10

∅ d1/d2

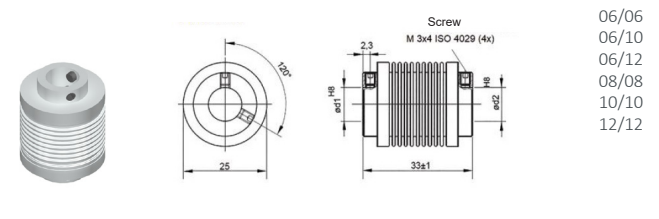

06/06  
06/10  
06/12  
08/08  
10/10  
12/12

### BFA 1622

Ordering code example: BFA 1622 06/06

∅ d1/d2

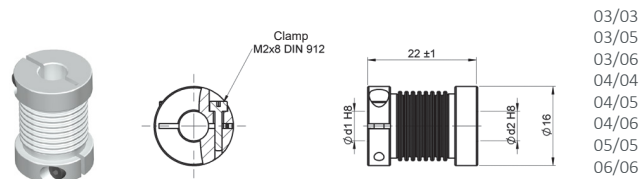

03/03  
03/05  
03/06  
04/04  
04/05  
04/06  
05/05  
06/06

### BFA 2129

Ordering code example: BFA 2129 10/10

∅ d1/d2

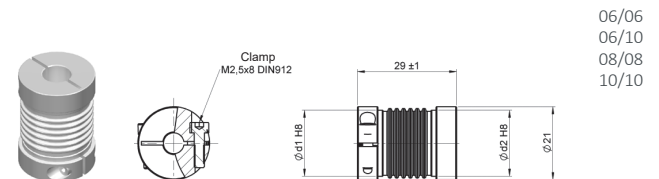

06/06  
06/10  
08/08  
10/10

### BFA 2135

Ordering code example: BFA 2135 06/10

∅ d1/d2

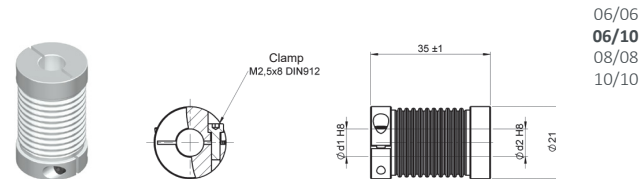

06/06  
**06/10**  
08/08  
10/10

### BFA 2435

Ordering code example: BFA 2435 12/12

∅ d1/d2

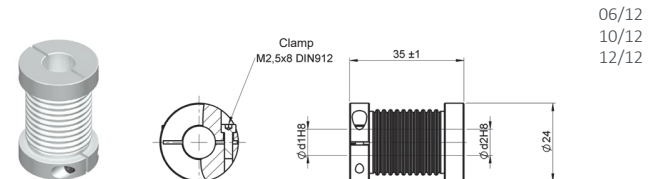

06/12  
10/12  
12/12

Printed in bold = Immediate delivery. Check with us the delivery time for the other options.  
Other shaft diameter available, upon request.

# BELLOW-FLEX

## FLEXIBLE METAL BELLOWS COUPLINGS

### BFA 2537

Ordering code example: BFA 2537 08/08

Ø d1/d2

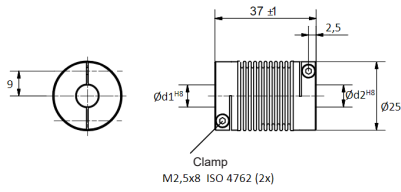

06/06  
06/10  
08/08  
10/10  
12/12

**Printed in bold** = Immediate delivery. Check with us the delivery time for the other options.  
Other shaft diameter available, upon request.